



75 Monmouth Road

Portsmouth, PO2 8BT

Offers in the region of £260,000



THREE BEDROOM DOUBLE BAY & FORECOURT HOMEMODERN THROUGHOUT***KITCHEN DINER TO THE REAR***DOWNSTAIRS WC***WEST FACING GARDEN***



Situated on the popular Monmouth Road in Portsmouth, this well-presented three-bedroom mid-terraced home offers spacious and modern accommodation ideal for families, professionals, or investors alike.

The property welcomes you with a bright and generously sized lounge featuring a bay window to the front, creating a light and comfortable living space. The hallway benefits from a cleverly converted under-stairs area, providing valuable additional storage. To the rear, there is a modern kitchen/diner fitted with attractive shaker-style wall and base units, offering ample storage for a family. The kitchen features tiled flooring and patio doors providing direct access to the garden, making it a great space for both everyday living and entertaining. Additional ground-floor features include a convenient downstairs WC, a lean-to accessed from the side of the kitchen, and a useful storage shed in the garden.

Upstairs, the property offers three bedrooms comprising two large double rooms and a well-proportioned single bedroom, along with a modern family bathroom. The home has been well maintained and updated, with a boiler installed in 2019 and serviced annually, replacement windows, improvements to the rear elevation, and downstairs electrics replaced within the last six months.

Externally, the west-facing garden enjoys afternoon and evening sun, providing an ideal space for outdoor dining and relaxation.

The location is a real highlight, with the Mountbatten Centre close by, Hilsea shoreline footpath and playing grounds within a pleasant 10-minute walk, and London Road shops just a five-minute walk away. The property also falls within the school catchment area for Stamshaw Infant and Junior Schools, Mayfield School, and Trafalgar School.

This is a fantastic opportunity to acquire a well-maintained home in a convenient and sought-after residential area of Portsmouth.

Area Map



Floor Plans

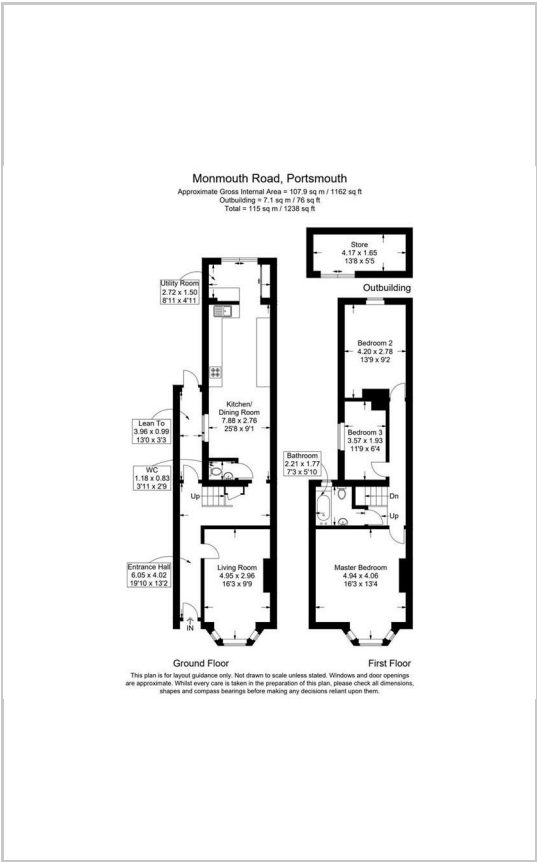

Energy Efficiency Graph

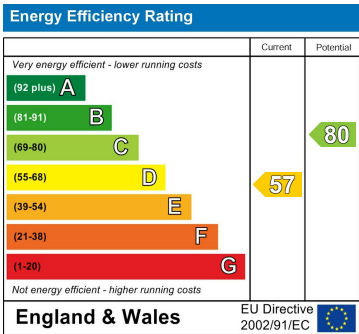

These particulars, whilst believed to be accurate are set out as a general outline only for guidance and do not constitute any part of an offer or contract. Intending purchasers should not rely on them as statements of representation of fact, but must satisfy themselves by inspection or otherwise as to their accuracy. No person in this firms employment has the authority to make or give any representation or warranty in respect of the property.